

INSET A

VIEWPORT A

- NOTES:**
- 1. DRAWINGS TO BE PRINTED IN COLOUR TO ENABLE CORRECT VIEWING OF SYMBOLS.
 - 2. DO NOT SCALE.
 - 3. COLOURS USED FOR ILLUSTRATIVE PURPOSES ONLY.

KEY:

- PROPOSED ROAD MARKINGS
- PROPOSED CYCLE SYMBOLS.
- PROPOSED SIGN.
- EXISTING ROAD MARKINGS
- PROPOSED KERB
- PROPOSED BOUNDARY OF MULTI USER FACILITY
- PROPOSED CROSSING
- PROPOSED UPGRADE TO EXISTING CROSSING
- PROPOSED ONE WAY PRIORITY WORKING
- EXISTING TRAFFIC SIGNALS UPGRADE
- PROPOSED MULTI USER FACILITY SIGN

P01	08/05/25	ORIGINAL	KP	AC	PB	PB	
Rev	Rev. Date	Purpose of revision	Drawn	Checked	Rev'd	Apprv'd	

Jacobs
7th Floor, 2 Colmore Square, 38 Colmore Circus
Queen'sway, Birmingham, B4 6BN
Tel: +44(0)121 237 4000 www.jacobs.com

Client

DERBYSHIRE
County Council

Project

**HOPE VALLEY
MULTI USER ACTIVE TRAVEL ROUTE**

Drawing title

**CONSULTATION DRAWINGS
A6187 Arthurs Way (Castleton)
to Mill Lane (Castleton)
SHEET 1 OF 5**

Drawing status

S1 - Suitable for Consultation





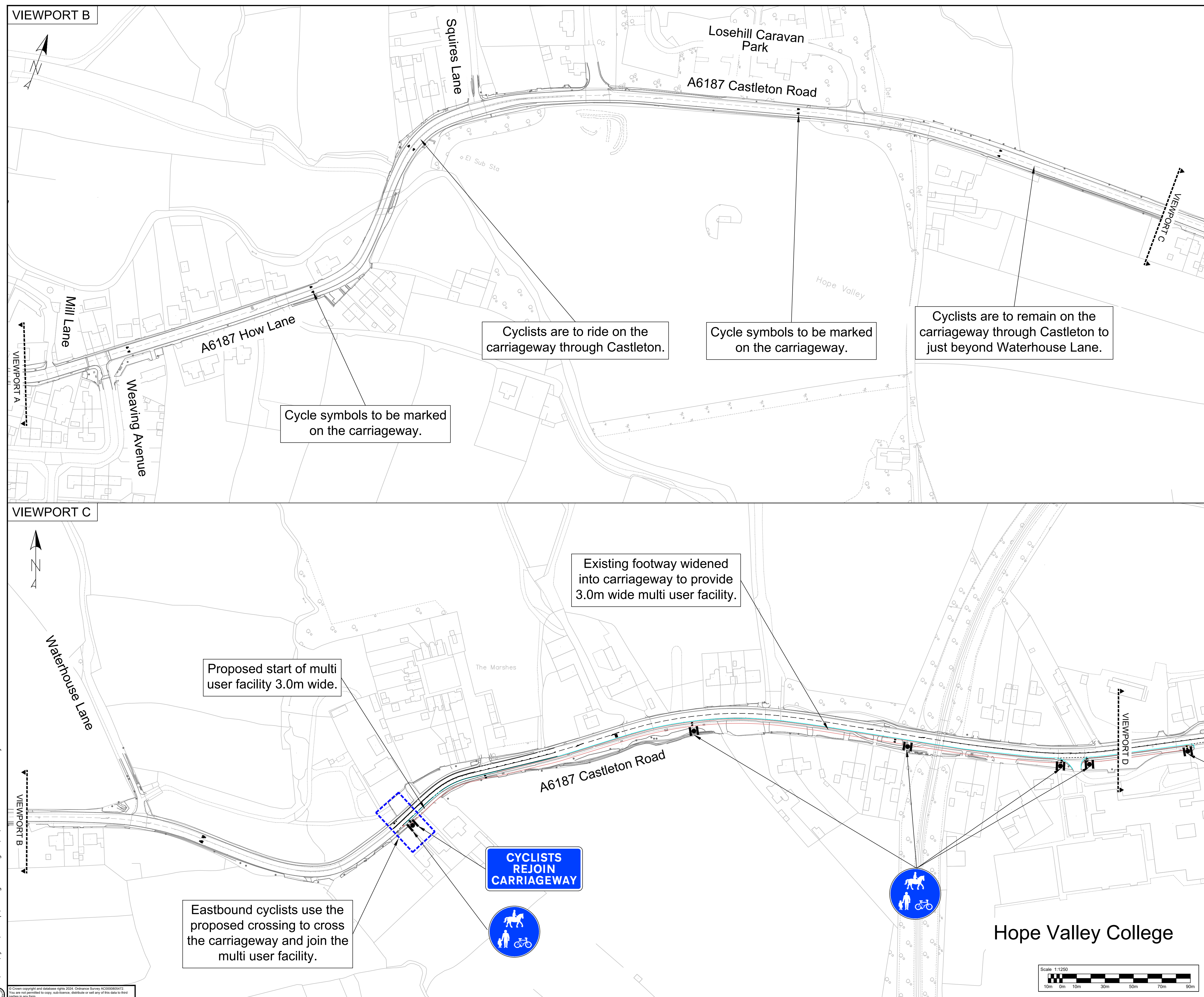





Scale	AS SHOWN	DO NOT SCALE
Jacobs No.	BDP00029	
Client no.	-	
Drawing number	BDP00029-JAC-GEN-HVCD-DR-CH-0001	Rev P01

© Copyright 2024 Jacobs U.K. Limited. The concepts and information contained in this document are the property of Jacobs. Use or copying of this document in whole or in part without the written permission of Jacobs constitutes an infringement of copyright. Limitation: This drawing has been prepared on behalf of, and for the exclusive use of Jacobs Client, and is subject to, and issued in accordance with, the provisions of the contract between Jacobs and the Client. Jacobs accepts no liability or responsibility whatsoever for, or in respect of, any use of, or reliance upon, this drawing by any third party.



- NOTES:**
1. DRAWINGS TO BE PRINTED IN COLOUR TO ENABLE CORRECT VIEWING OF SYMBOLS.
 2. DO NOT SCALE.
 3. COLOURS USED FOR ILLUSTRATIVE PURPOSES ONLY.

KEY:

- | | |
|---|--|
|  | PROPOSED ROAD MARKINGS |
|  | PROPOSED CYCLE SYMBOLS. |
|  | PROPOSED SIGN. |
|  | EXISTING ROAD MARKINGS |
|  | PROPOSED KERB |
|  | PROPOSED BOUNDARY OF MULTI USER FACILITY |
|  | PROPOSED CROSSING |
|  | PROPOSED UPGRADE TO EXISTING CROSSING |
|  | PROPOSED ONE WAY PRIORITY WORKING |
|  | EXISTING TRAFFIC SIGNALS UPGRADE |
|  | PROPOSED MULTI USER FACILITY SIGN |

P01	08/05/25	ORIGINAL	KP	AC	PB	PB
Rev	Rev. Date	Purpose of revision	Drawn	Checked	Rev'd	Apprv'd

Jacobs

7th Floor, 2 Colmore Square, 38 Colmore Circus
Queensway, Birmingham, B4 6BN
Tel: +44(0)121 237 4000 www.jacobs.com



Project	HOPE VALLEY MULTI USER ACTIVE TRAVEL ROUTE
---------	---

Drawing title

CONSULTATION DRAWINGS
A6187 Mill Lane (Castleton)
to Hope Valley College (Hope)
SHEET 2 OF 5

Drawing status	S1 - Suitable for Consultation
----------------	--------------------------------

Scale	AS SHOWN	DO NOT SCALE
-------	----------	--------------

Jacobs No.	BDP00029
Client no.	-

Drawing number	Rev
BDP00029-JAC-GEN-HVCD-DR-CH-0002	P01

© Copyright 2024 Jacobs U.K. Limited. The concepts and information contained in this document are the property of Jacobs. Use or copying of this document in whole or in part without the written permission of Jacobs constitutes an infringement of copyright. Limitation: This drawing has been prepared on behalf of, and for the exclusive use of Jacobs' Client, and is subject to, and issued in accordance with, the provisions of the contract between Jacobs and the Client. Jacobs accepts no liability or responsibility whatsoever for or in respect of any use of the contract between Jacobs and the Client by any third party.

Hope

**CYCLISTS
REJOIN
CARRIAGEWAY**

Proposed crossing upgrade.

Proposed crossing upgrade.

Existing footway widened into carriageway to provide 3.0m wide multi user facility.

Multi user facility ends at the carpark. Cyclists use the crossing to cross the carriageway and continue heading eastbound on-carriageway.

School Lane realignment to narrow junction and formalise parking spaces, including for disabled users.

Eastbound cyclists to use the crossing to cross the carriageway and join the multi user facility.

**CYCLISTS
REJOIN
CARRIAGEWAY**

Cycle symbols to be marked
on the carriageway.

VIEWPORT E

A6187 Station Road

Station Road

A6187 Hope Road

Start of multi user facility
between 2.0-3.0m wide.

Proposed crossing to allow pedestrians and cyclists to cross the carriageway in both directions to continue on the multi user facility.

Proposed multi user
facility 3.0m wide.

Existing footway widened into carriageway to provide 3.0m wide multi user facility.

Scale 1:1250



A horizontal scale bar with alternating black and white segments. Below the bar, numerical labels indicate distances: 10m, 0m, 10m, 30m, 50m, 70m, and 90m. The segments represent 10m intervals.

NOTES:

1. DRAWINGS TO BE PRINTED IN COLOUR TO ENABLE CORRECT VIEWING OF SYMBOLS.
2. DO NOT SCALE.
3. COLOURS USED FOR ILLUSTRATIVE PURPOSES ONLY.

KEY:

- | | |
|---|--|
|  | PROPOSED ROAD MARKINGS |
|  | PROPOSED CYCLE SYMBOLS. |
|  | PROPOSED SIGN. |
|  | EXISTING ROAD MARKINGS |
|  | PROPOSED KERB |
|  | PROPOSED BOUNDARY OF MULTI USER FACILITY |
|  | PROPOSED CROSSING |
|  | PROPOSED UPGRADE TO EXISTING CROSSING |
|  | PROPOSED ONE WAY PRIORITY WORKING |
|  | EXISTING TRAFFIC SIGNALS UPGRADE |
|  | PROPOSED MULTI USER FACILITY SIGN |

P01	08/05/25	ORIGINAL	KP	AC	PB	PB
Rev	Rev. Date	Purpose of revision	Drawn	Checked	Rev'd	Approved

Jacobs

7th Floor, 2 Colmore Square, 38 Colmore Circus
Queensway, Birmingham, B4 6BN
Tel: +44(0)121 237 4000 www.jacobs.com

Client



Prole

Project

HOPE VALLEY MULTI USER ACTIVE TRAVEL ROUTE

Drawing title

CONSULTATION DRAWINGS
A6187 Hope Valley College (Hope)
to east of Station Road junction (Hope)
SHEET 3 OF 5

Drawing status

S1 - Suitable for Consultation

Scale

Scale	AS SHOWN
Jacobs No.	BDP00029

Client no.

Drawing number

BDP00029-JAC-GEN-HVCD-DR-CH-0003

PO-1

© Copyright 2024 Jacobs U.K. Limited. The concepts and information contained in this document are the property of Jacobs. Any use or copying of this document in whole or in part without the written permission of Jacobs constitutes an infringement of copyright. This document is confidential. It has been prepared on behalf of and for the exclusive use of the Jacobs Client, and is subject to and issued in accordance with the provisions of the contract between Jacobs and the Client. Jacobs accepts no liability or responsibility whatsoever for, or in respect of, any use of, or reliance upon, this document by any third party.

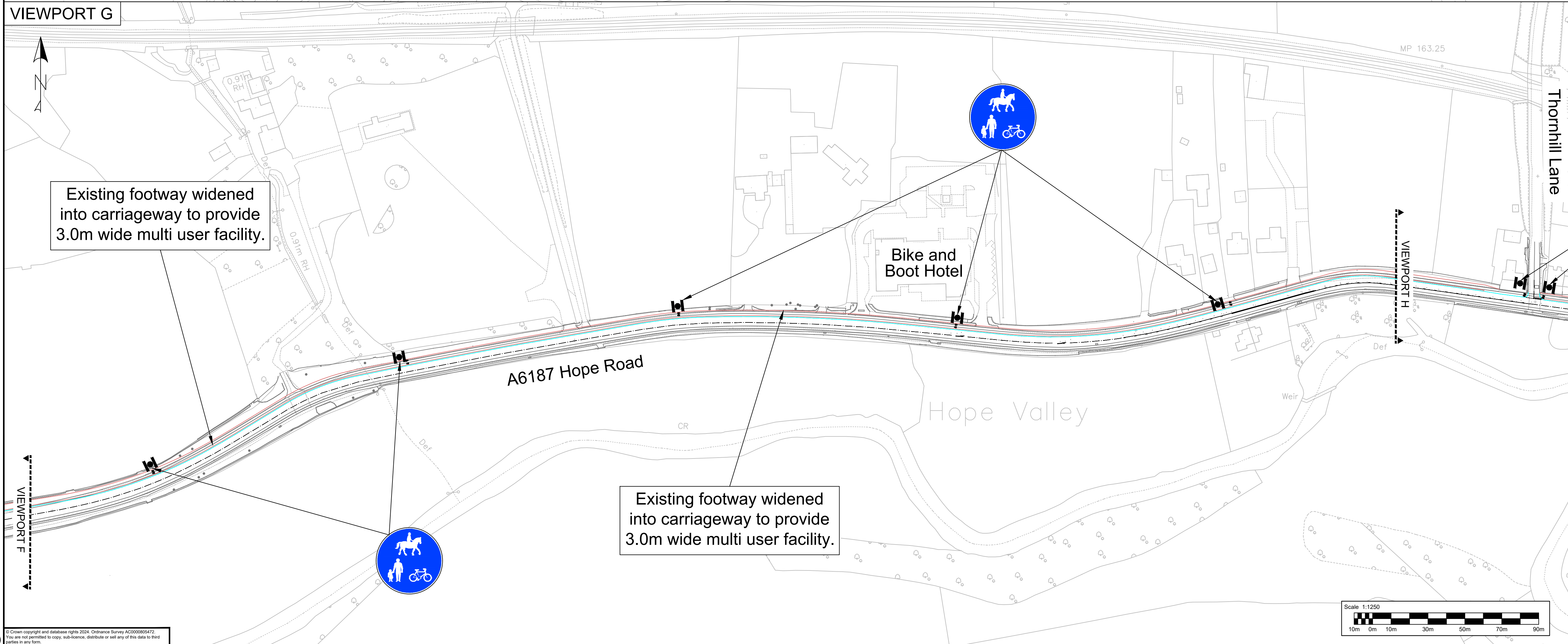
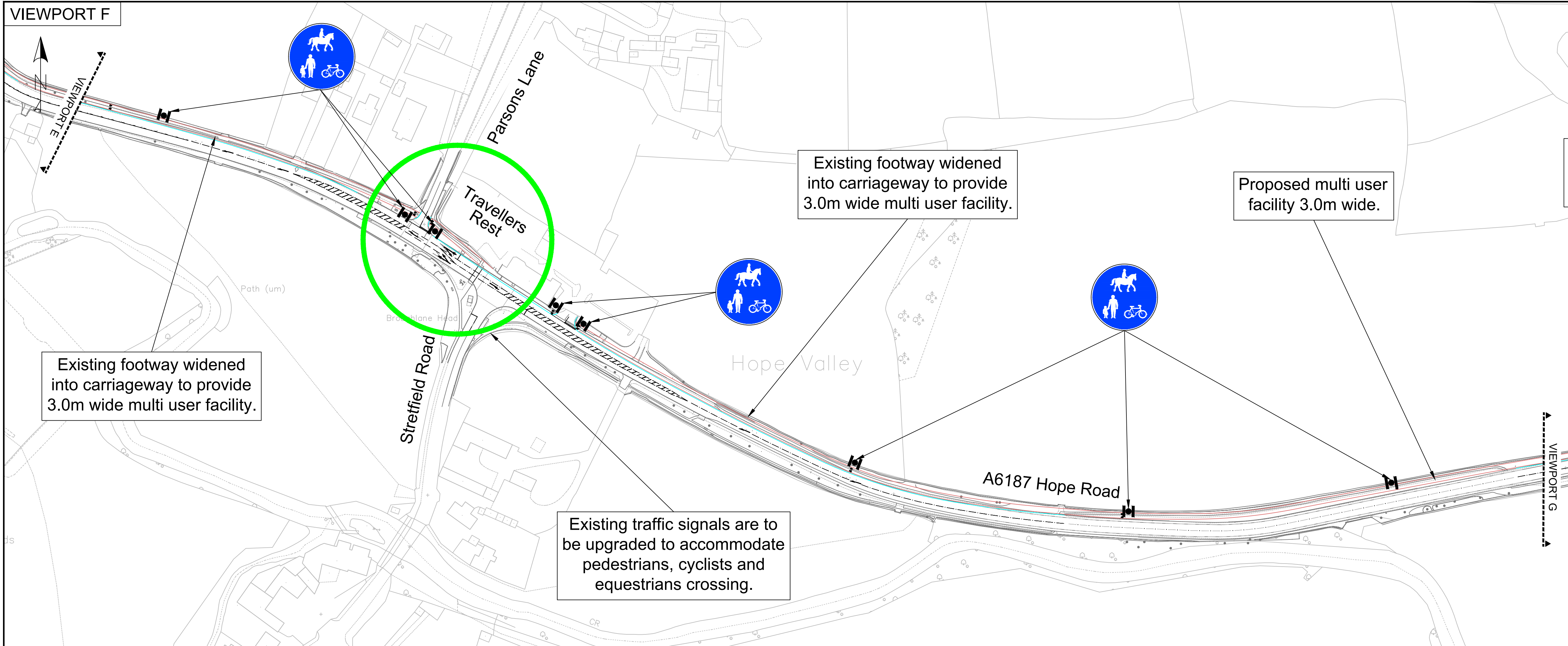

NOTES:

- DRAWINGS TO BE PRINTED IN COLOUR TO ENABLE CORRECT VIEWING OF SYMBOLS.
- DO NOT SCALE.
- COLOURS USED FOR ILLUSTRATIVE PURPOSES ONLY.

KEY:

- PROPOSED ROAD MARKINGS
- PROPOSED CYCLE SYMBOLS.
- PROPOSED SIGN.
- EXISTING ROAD MARKINGS
- PROPOSED KERB
- PROPOSED BOUNDARY OF MULTI USER FACILITY
- PROPOSED CROSSING
- PROPOSED UPGRADE TO EXISTING CROSSING
- PROPOSED ONE WAY PRIORITY WORKING
- EXISTING TRAFFIC SIGNALS UPGRADE
- PROPOSED MULTI USER FACILITY SIGN

Rev	Rev. Date	Purpose of revision	Drawn	Checkd	Rev'd	Apprv'd
P01	08/05/25	ORIGINAL	KP	AC	PB	PB

Jacobs
7th Floor, 2 Colmore Square, 38 Colmore Circus
Queen'sway, Birmingham, B4 6BN
Tel: +44(0)121 237 4000 www.jacobs.com

Client: **DERBYSHIRE County Council**

Project: **HOPE VALLEY MULTI USER ACTIVE TRAVEL ROUTE**

Drawing title: **CONSULTATION DRAWINGS**
A6187 west of Parsons Lane (Hope Valley)
to Thornhill Lane (Hope Valley)
SHEET 4 OF 5

Drawing status: **S1 - Suitable for Consultation**





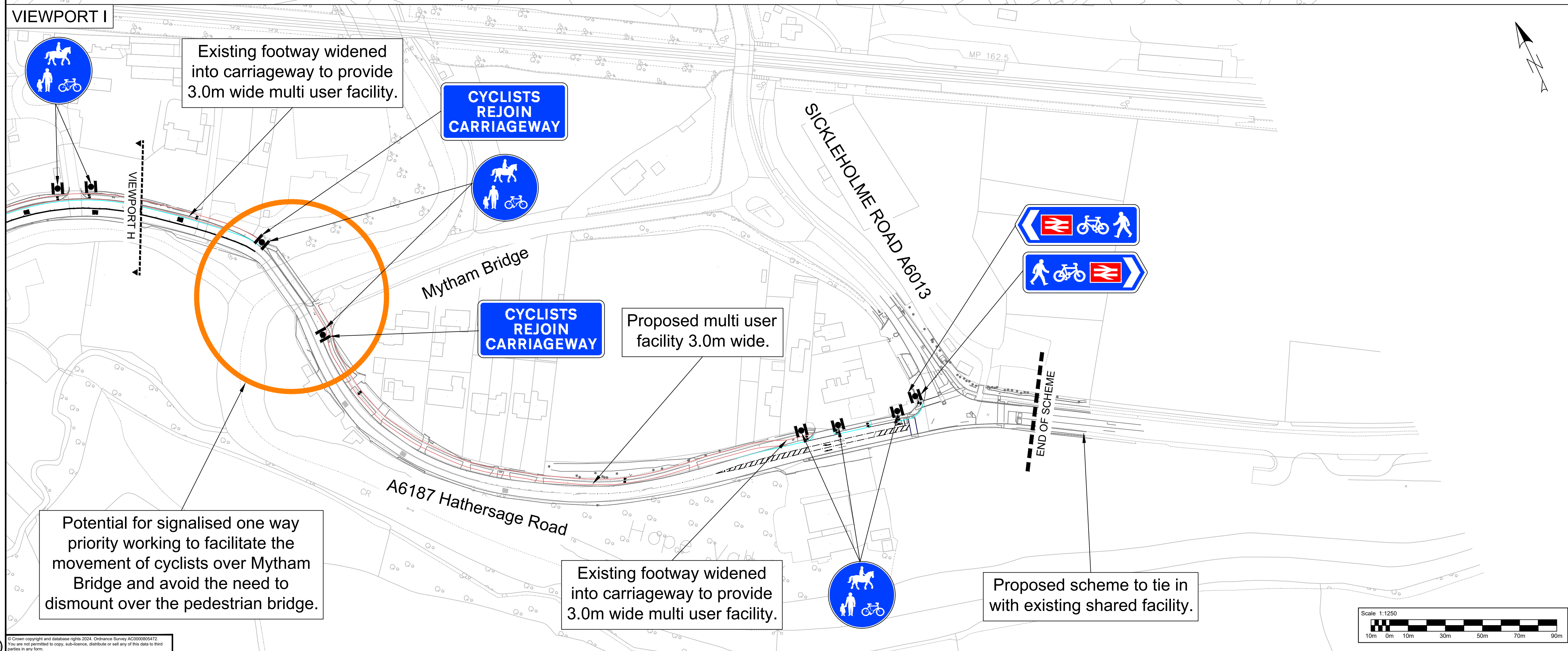
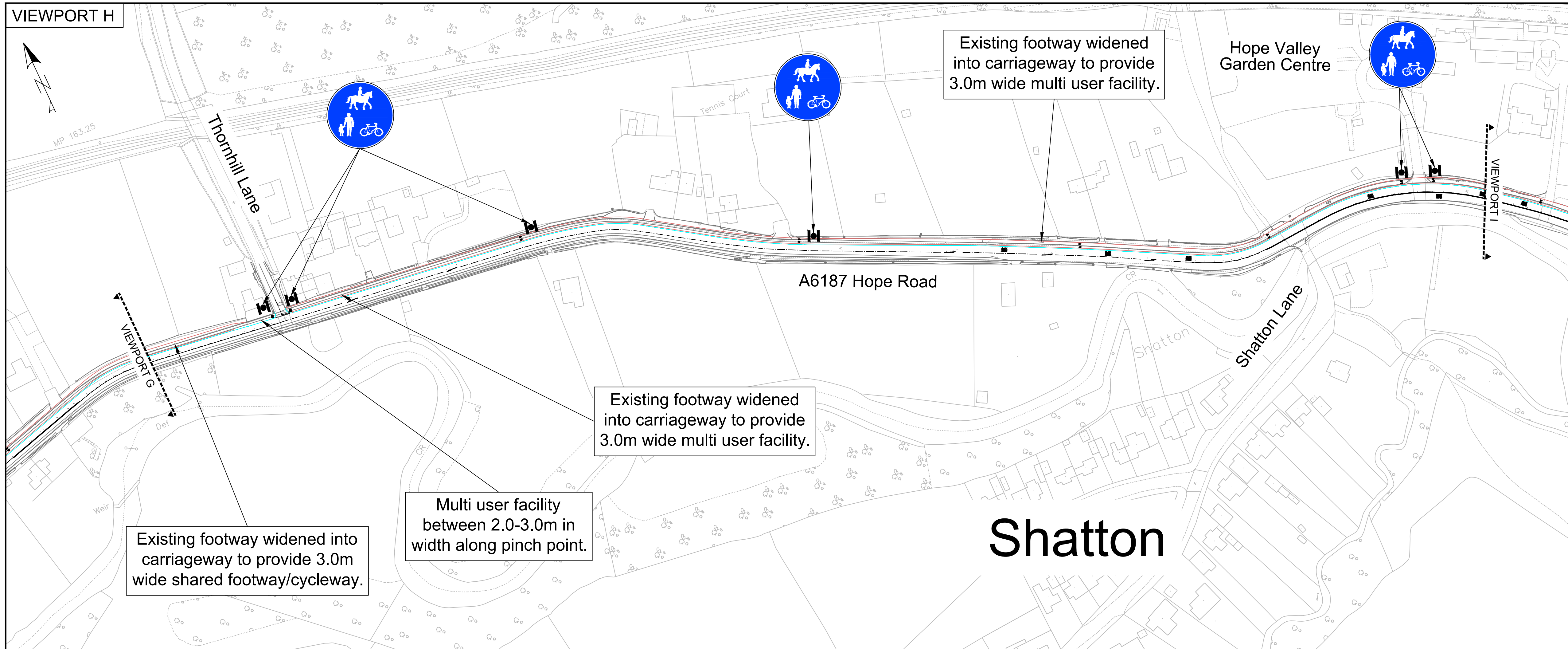





Scale	AS SHOWN	DO NOT SCALE
Jacobs No.	BDP00029	
Client no.	-	
Drawing number	BDP00029-JAC-GEN-HVCD-DR-CH-0004	Rev P01

© Copyright 2024 Jacobs U.K. Limited. The concepts and information contained in this document are the property of Jacobs. Use or copying of this document in whole or in part without the written permission of Jacobs constitutes an infringement of copyright. Limitation: This drawing has been prepared on behalf of, and for the exclusive use of Jacobs Client, and is subject to, and issued in accordance with, the provisions of the contract between Jacobs and the Client. Jacobs accepts no liability or responsibility whatsoever for or in respect of, any use of, or reliance upon, this drawing by any third party.



- NOTES:**
1. DRAWINGS TO BE PRINTED IN COLOUR TO ENABLE CORRECT VIEWING OF SYMBOLS.
 2. DO NOT SCALE.
 3. COLOURS USED FOR ILLUSTRATIVE PURPOSES ONLY.

KEY:

- | | |
|---|--|
|  | PROPOSED ROAD MARKINGS |
|  | PROPOSED CYCLE SYMBOLS. |
|  | PROPOSED SIGN. |
|  | EXISTING ROAD MARKINGS |
|  | PROPOSED KERB |
|  | PROPOSED BOUNDARY OF MULTI USER FACILITY |
|  | PROPOSED CROSSING |
|  | PROPOSED UPGRADE TO EXISTING CROSSING |
|  | PROPOSED ONE WAY PRIORITY WORKING |
|  | EXISTING TRAFFIC SIGNALS UPGRADE |
|  | PROPOSED MULTI USER FACILITY SIGN |

PO1	08/05/2025	ORIGINAL	KP	AC	PB	PB
Rev	Rev. Date	Purpose of revision	Drawn	Checked	Rev'd	Apprv'd

Jacobs

7th Floor, 2 Colmore Square, 38 Colmore Circus
Queensway, Birmingham, B4 6BN
Tel: +44(0)121 237 4000 www.jacobs.com

Client



Project

Project HOPE VALLEY MULTI USER ACTIVE TRAVEL ROUTE

Drawing title

Drawing title

CONSULTATION DRAWINGS

A6187 Thornhill Lane (Hope Valley)
to A6013 Sicklesholme Road (Hope Valley)

SHEET 5 OF 5

Drawing status

Drawing status		
S1 - Suitable for Consultation		
Scale	AS SHOWN	DO NOT SCALE

Jacobs N

Client no.	-
Drawing number	Rev BDP00029-JAC-GEN-HVCD-DR-CH-0005 P01

© Copyright 2024 Jacobs U.K Limited. The concepts and information contained in this document are the property of Jacobs. Use or copying of this document in whole or in part without the written permission of Jacobs constitutes an infringement of copyright. Limitation: This drawing has been prepared on behalf of, and for the exclusive use of Jacobs' Client, and is subject to, and issued in accordance with, the provisions of the contract between Jacobs and the Client. Jacobs accepts no liability or responsibility whatsoever for, or in respect of, advice or reliance upon, this drawing by any third party.