

SAFETY, HEALTH AND ENVIRONMENTAL INFORMATION BOX

IT IS ASSUMED THAT ALL WORKS ON THIS DRAWING WILL BE CARRIED OUT BY A COMPETENT CONTRACTOR WORKING, WHERE APPROPRIATE, TO AN APPROPRIATE METHOD STATEMENT.

THIS DRAWING IS TO BE USED ONLY FOR THE PURPOSE OF ISSUE THAT IT WAS INTENDED FOR AND IS SUBJECT TO AMENDMENT.

KEY

- CARRIAGEWAY
- NEW FOOTWAYS AND PAVED AREAS
- NEW CYCLE WAY
- EXISTING CYCLE ROUTE
- PHASE 2
- JUNCTIONS SUBJECT TO ONGOING STUDY

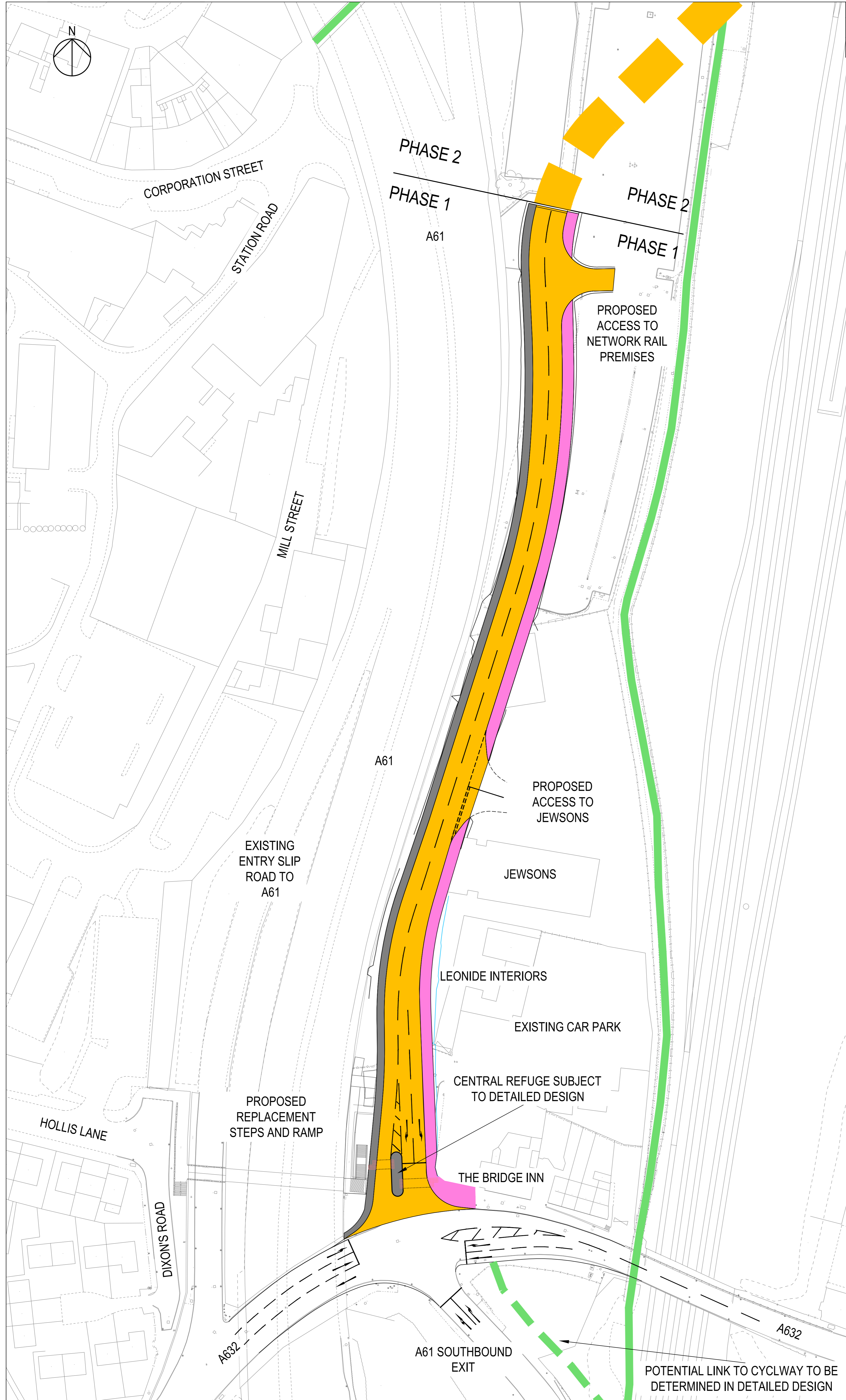

Plot Date : PLOT_DAT
File Name : DWGNAME

Revision Details	By	Date	Suffix
	Check		
Purpose of issue	Client	DERBYSHIRE County Council	
FOR INFORMATION			

NOTES

- THIS DRAWING IS TO BE READ IN CONJUNCTION WITH ALL OTHER RELEVANT DOCUMENTATION.
- DO NOT SCALE FROM THIS DRAWING. USE ONLY PRINTED DIMENSIONS.
- ALL DIMENSIONS IN METRES. ALL CHAINAGES, LEVELS AND COORDINATES ARE IN METRES UNLESS DEFINED OTHERWISE.
- THIS DRAWING IS BASED ON ORDNANCE SURVEY DATA AND TOPOGRAPHICAL SURVEY PROVIDED BY DERBYSHIRE COUNTY COUNCIL.

Project Title
HOLLIS LANE LINK DESIGN

Drawing Title
PHASE 1 PROPOSED DESIGN

Designed NAC	Drawn NAC	Checked DJH	Approved MD	Date
AECOM Internal Project No. 60581983		Subsidiary		
Scale @ A1 1:500		Zone		

THIS DOCUMENT HAS BEEN PREPARED PURSUANT TO AND SUBJECT TO THE TERMS OF AECOM'S APPOINTMENT BY ITS CLIENT. AECOM ACCEPTS NO LIABILITY FOR ANY USE OF THIS DOCUMENT OTHER THAN BY ITS ORIGINAL CLIENT OR FOLLOWING AECOM'S EXPRESS AGREEMENT TO SUCH USE, AND ONLY FOR THE PURPOSES FOR WHICH IT WAS PREPARED AND PROVIDED.

© Crown copyright and database rights 2019. Ordnance Survey 100023251. You are not permitted to copy, sub-license, distribute or sell any of this data to third parties in any form.

AECOM
Royal Court, Basil Close
Chesterfield
S41 7SL
Tel: +44 (0) 1246 209 221
Fax: +44 (0) 1246 209 229
www.aecom.com

Drawing Number
HLL-AEC-XX-DR-PE-00002

Rev
A