

CHARTED TERRITORY

Linking the present to the past

Historic maps allow us to reconnect with lost information, letting us experience the landscape as previous generations would have known it.



Bridge Hill in Belper has twice been transformed. In the 1790s terracing allowed the creation of Bridgehill House, with large flat lawns and gardens. After the Second World War the hillside was transformed into a modern housing estate. These plans show the estate as it was in 1888 and the proposals, made in 1937, for the post-war development which included new public roads. One of these, Lodge Drive, replaces the old carriageway from East Lodge to Bridgehill House.

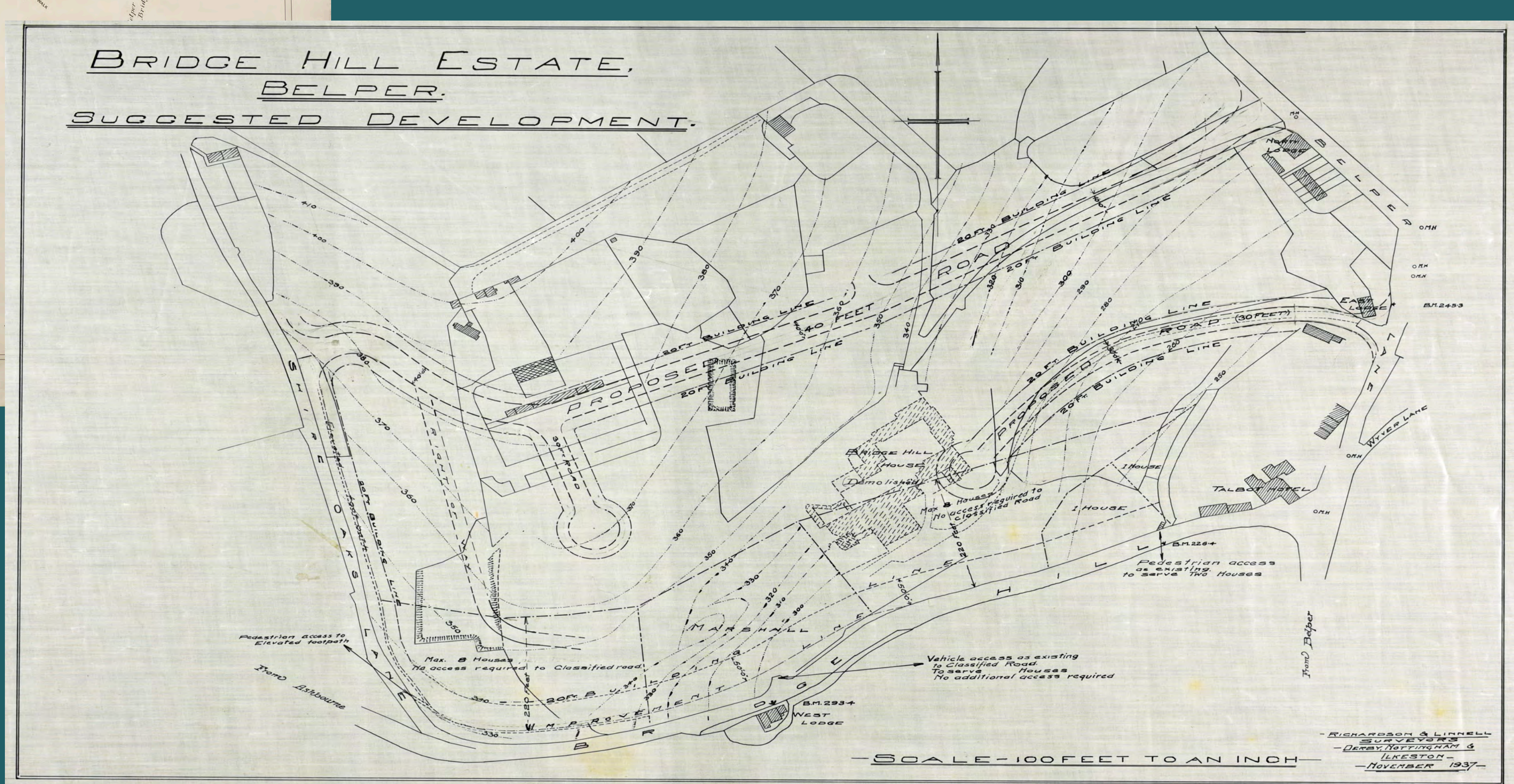

Digital copies of maps make it easier to see changes over time: we can layer the old map over a present day one, as shown here with these two maps of Belper. The roads and brook match up beautifully, demonstrating the skill of the 1840s surveyor. It is also obvious where new roads have been added.

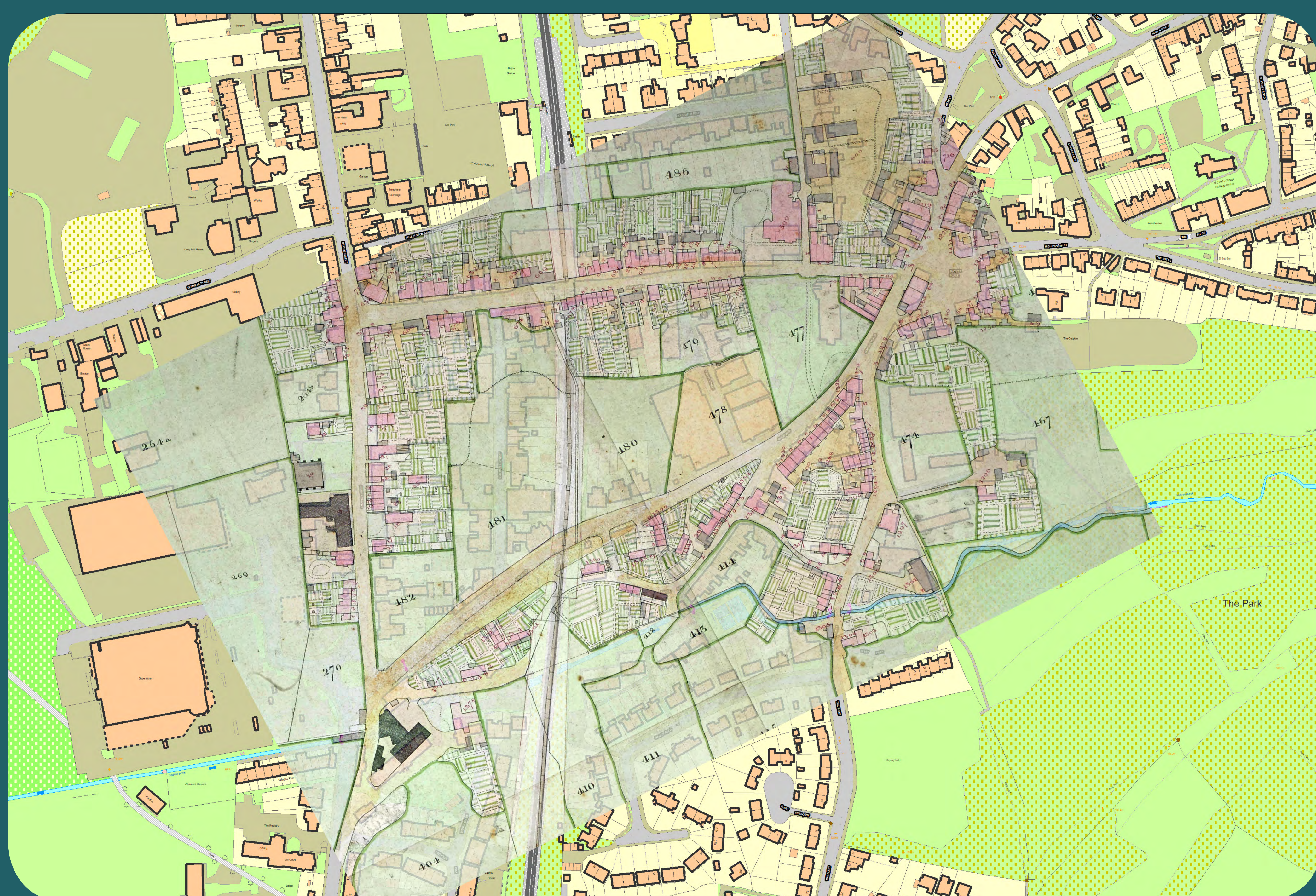

This 1819 map of Belper shows that what is now Field Lane was once the Hutfall Field Footway. The Hutfall was the name for Belper's huge village field, but by the 20th century the name was no longer used. In 2017 a new road and development off Field Lane was named 'The Hutfall', as a nod to Belper's past.



Charted Territory is a Derwent Valley Mills World Heritage Site Partnership project, funded by the Great Place Scheme and delivered by Derbyshire Record Office.